



**43/5 Gladstone Road CASTLE HILL NSW**



Rare opportunity to purchase warehouse/office within the popular Quantum Corporate Park Castle Hill, one of the most sought out industrial parks in Castle Hill.

Located just off Victoria Avenue and next door to a popular Homemaker Centre, Quantum Corporate Park will suit a range of occupants.

The complex presents as new, with an impressive building facade giving your business a professional presentation. Offering wide driveways which provide easy vehicular access for larger deliveries.

Generously proportioned landscaped spaces provide an

[For full version visit the website](https://www.hillscentral.com.au)

**Type** : Industrial  
**Building Size** : 239 sqm  
**View** : <https://www.hillscentral.com.au/sale/nsw/hills/castle-hill/commercial/industrial/8401646>



**Simon Russo**  
02 9634 2299

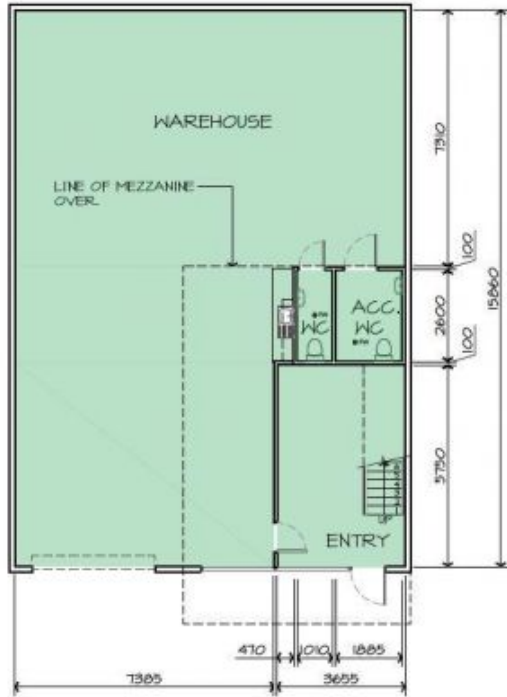

**GROUND FLOOR**  
NLA 174.7m<sup>2</sup>



**MEZZANINE FLOOR**  
NLA 56.1m<sup>2</sup>

**PRELIMINARY ISSUE  
NOT FOR CONSTRUCTION**

© 2015 R.J. SINCLAIR Pty Limited. All rights reserved.  
Consent to these drawings and conditions is granted by R.J. SINCLAIR Pty Limited

No.	Description	Date
PI	PRELIMINARY ISSUE. NOT FOR CONSTRUCTION	16.04.15



AS/NZS 1906:2009  
ARCHITECTURAL DRAWINGS  
CONVENTIONAL PRACTICE  
DRAWING CODE



**R.J. SINCLAIR** Pty Ltd  
Building Design  
Office Suite 211 - 50 Stm  
Northmead Business Park  
33 Langdon Drive  
Northmead, NSW 2151  
Phone: (61) 6155 8100  
Fax: (61) 6155 8101  
Mobile: (61) 9959 1216  
Phone: 02 9959 1216  
Email: info@rjsinclair.com.au  
http://www.rjsinclair.com.au  
Architectural - Structural - Project Management

Project  
**KELLYRIDGE HOMES OFFICE**  
UNIT 43 / 5 GLADSTONE ROAD  
CASTLE HILL 2154  
FOR  
**BARRY MORRIS**  
Drawing Title  
**EXISTING PLAN**

Approved	Designed	
	RJS	
Date	Drawn	
17th SEPTEMBER 2015	AM	
Scale	Checked	
1:100		
Project No.	Drawng No.	Rev.
15 - 071	A - 01	PI