

## 20 Harvey Road KINGS PARK NSW

### TORRENS TITLED WAREHOUSE

First National Commercial Hills Central is proud to present 20 Harvey Rd, Kings Park for Auction 16th September 2022 (if not sold prior)

Located in a high exposure area of Kings Park industrial precinct this property offers many benefits.

#### Features include:

Freestanding Torrens Title - No Strata Fees!

Land area 492m? (approx.)

Building Area 263m? (approx)

Signage opportunity with exposure to 1,000's of passengers daily on Sydney Rail

[For full version visit the website](https://www.hillscentral.com.au)

**Type** : Industrial  
**Building Size** : 263 sqm  
**View** : <https://www.hillscentral.com.au/sale/nsw/western-sydney/kings-park/commercial/industrial/8401662>

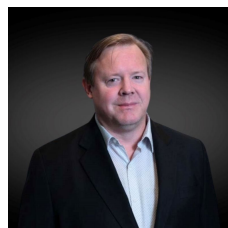

**Damien Austin**  
02 9634 2299

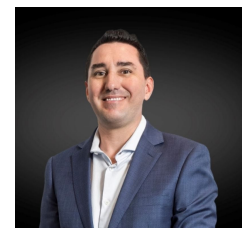

**Simon Russo**  
02 9634 2299

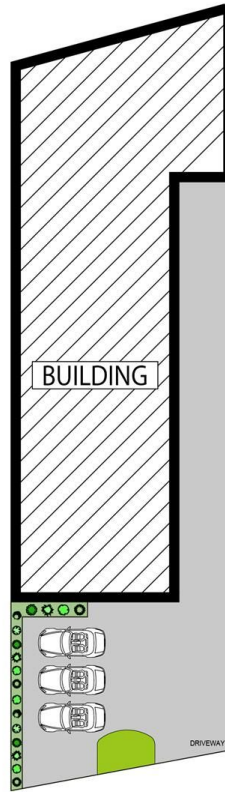
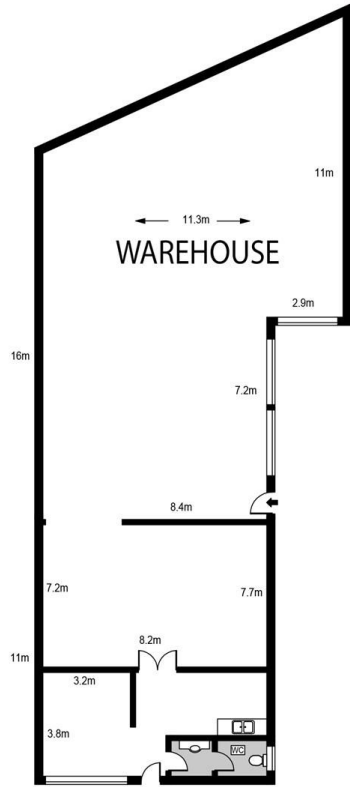

SITE PLAN (NOT TO SCALE)



20 Harvey Road, Kings Park