



# firstnational COMMERCIAL | Hills Central



**Agent:**  
**Simon Russo**  
0414 678 632  
Simon@Hillscentral.com.au

**SOLD: \$1,150,000**  
**Excellent Rate: Over \$7000 Per Sqm**

**firstnational**  
**COMMERCIAL**  
Hills Central

157m<sup>2</sup>  
6 car spaces

Approved  
Mechanic  
E1 (Local  
Centre) zoning

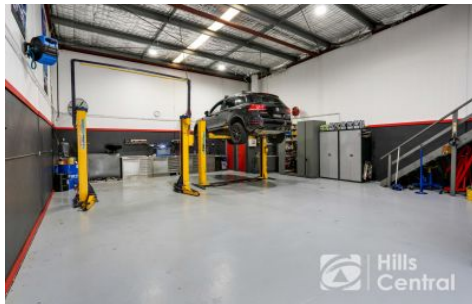

## 25/286-288 New Line Road DURAL NSW



### APPROVED MECHANIC | POPULAR COMPLEX

Excellent location at the centre of one of Dural's most active locations, Dural Business Park. This complex is located only 8km to Castle Hill and with a short drive to major infrastructure such as Cherrybrook Metro, M2 motorway and NorthConnex, plus within proximity to Round Corner Dural.

The complex offers a great variety of businesses which includes mechanical use, gyms, martial arts, medical centre, bike showroom, as well as traditional warehouse users.

[For full version visit the website](https://www.hillscentral.com.au)

**Type** : Industrial  
**Building Size** : 191 sqm  
**View** : <https://www.hillscentral.com.au/sale/nsw/hills/dural/commercial/industrial/8401732>



**Simon Russo**  
02 9634 2299

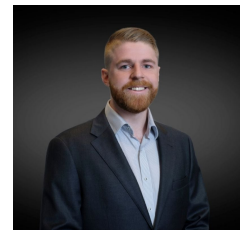

**Bailey Foxall**  
02 9634 2299

<https://www.hillscentral.com.au>

Suite 1/19-21 Terminus St, Castle Hill, NSW 2154  
T: 02 9634 2299 E: [info@hillscentral.com.au](mailto:info@hillscentral.com.au)

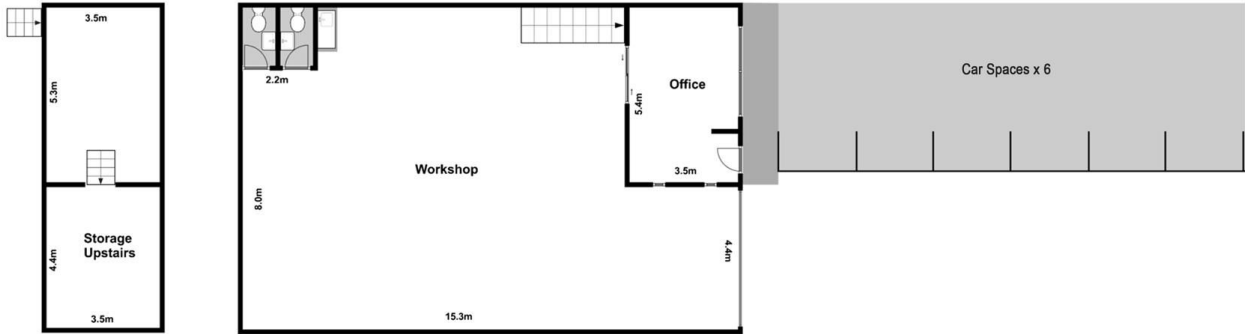

All Dimensions and figures contained in this advertisement are given in good faith and are believed to be correct. However, we cannot guarantee its accuracy and interested persons should rely on their own enquiries.

**25/286-288 New Line Rd, Dural**