

**19a/7-9 Barwell Avenue CASTLE HILL NSW**



Ground floor commercial suite on offer in the heart of Castle Hill CBD located in the Barwell Centre.

Known as the medical hub of Castle Hill, Barwell Centre offers convenient parking for customers and includes quality occupants such as a Medical Centre, Orthodontist, Eye Specialist, X-Ray, Physiotherapist plus others.

The suite itself is ground floor, open plan, including ducted air conditioning, internal amenities and has excellent exposure into the complex and McDonalds.

2 Car Spaces Plus Visitor Parking.

**Type** : Offices  
**Building Size** : 102 sqm  
**View** : <https://www.hillscentral.com.au/lease/nsw/hills/castle-hill/commercial/offices/8401860>

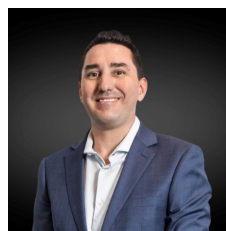

**Simon Russo**  
02 9634 2299

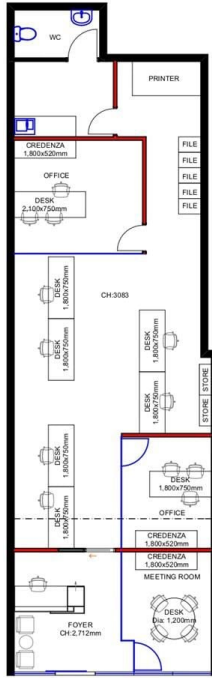

**PLEASE NOTE:**

DO NOT SCALE OFF DRAWING  
 DRAWINGS ARE CONCEPT ONLY & NOT TO BE USED AS CONSTRUCTION DRAWINGS  
 ALL DIMENSIONS ARE APPROXIMATE ONLY  
 ALL BUILDERS, JOINERS, ENGINEERS & CONTRACTORS ARE TO CONDUCT A SITE CHECK BEFORE COMMENCING ANY NEW BUILDING OR JOINERY WORKS & MUST ENSURE ALL TECHNICAL REQUIREMENTS ARE MET & ALL MATERIALS & FINISHES ARE TO THE ACCORDANCE OF THE SUPPLIERS DOCUMENTATION, AUSTRALIAN STANDARDS & BCA

**KWINTERIORS PTY LTD**  
 73 KENNEDY STREET, PICNIC POINT NSW 2213  
 ph: (02) 9792 3700 fax: (02) 9773 8164  
 mob: 0412 041 366  
 email: info@kwinteriors.com.au

	Sam Khall 7-9 Barwell Ave, CASTLE HILL	date: 12.09.2016	drawing No: N/A
title: FURNITURE PLAN		scale: @ A3	Revision: N/A
		1:100	