

19a/7-9 Barwell Avenue CASTLE HILL NSW

2

Ground Floor Medical Suite / Great Exposure

Opportunity to lease a ground floor 101.75m2 suite with parking right at the door.

Known as the medical hub of Castle Hill, Barwell Centre offers convenient parking for customers and includes quality occupants such as a Medical Centre, Orthodontist, Eye Specialist, X-Ray, Physiotherapist plus others. The Barwell Centre is located close to Castle Towers, Castle Hill metro, retail and specialists alike.

Outgoings \$5800 + GST (where applicable)

[For full version visit the website](https://www.hillscentral.com.au)

Type : Offices
Building Size : 102 sqm
View : <https://www.hillscentral.com.au/lease/nsw/hills/castle-hill/commercial/offices/8401999>

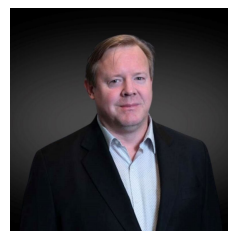

Damien Austin
02 9634 2299

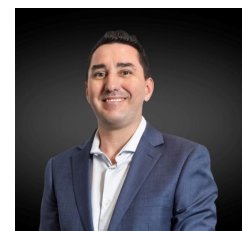

Simon Russo
02 9634 2299

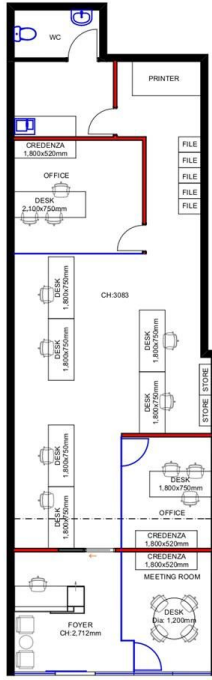

PLEASE NOTE:

DO NOT SCALE OFF DRAWING
 DRAWINGS ARE CONCEPT ONLY & NOT TO BE USED AS CONSTRUCTION DRAWINGS
 ALL DIMENSIONS ARE APPROXIMATE ONLY
 ALL BUILDERS, JOINERS, ENGINEERS & CONTRACTORS ARE TO CONDUCT A SITE CHECK BEFORE COMMENCING ANY NEW BUILDING OR JOINERY WORKS & MUST ENSURE ALL TECHNICAL REQUIREMENTS ARE MET & ALL MATERIALS & FINISHES ARE TO THE ACCORDANCE OF THE SUPPLIERS DOCUMENTATION, AUSTRALIAN STANDARDS & BCA

KWINTERIORS PTY LTD
 73 KENNEDY STREET, PICNIC POINT NSW 2213
 ph: (02) 9792 3700 fax: (02) 9773 8164
 mob: 0412 041 366
 email: info@kwinteriors.com.au

Sam Khali
 7-9 Barwell Ave, CASTLE HILL
 FURNITURE PLAN

date: 12.09.2016
 scale: @ A3
 1:100

drawing No: N/A
 Revision: N/A