

24a/7 Salisbury Road CASTLE HILL NSW



EXCELLENT LOCATION | POPULAR COMPLEX

Excellent opportunity with this outstanding strata office unit, strategically positioned just off Victoria Ave in the sought-after Castle Hill Trading Zone. This location ensures easy access to major arterial roads and motorways, making it a convenient hub for businesses. Within walking distance to Showground and Norwest Metro, as well as the HomeCo. Castle Hill, featuring shops and eateries.

Features Include:

- Ground floor showroom with split systems and a spacious lunchroom.
- First floor offices, with separate meeting room flooded

[For full version visit the website](https://www.hillscentral.com.au)

Type : Offices
Building Size : 131 sqm
View : <https://www.hillscentral.com.au/lease/nsw/hills/castle-hill/commercial/offices/8402234>

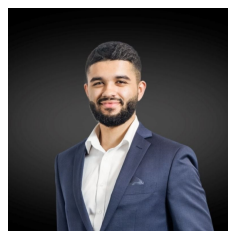

Zartosht Sundal
02 9634 2299

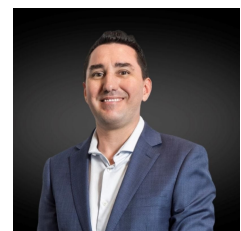

Simon Russo
02 9634 2299

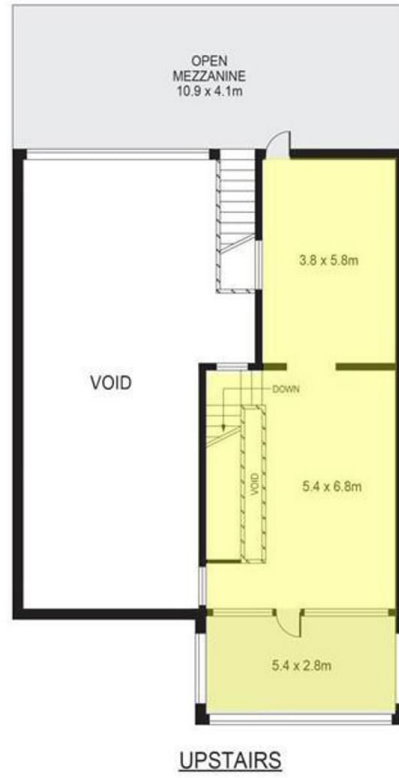
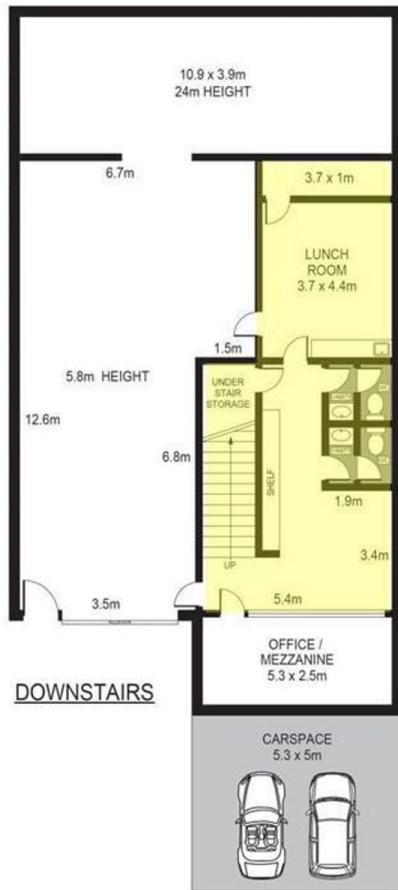

24/7 Salisbury Road, Castle Hill