



9 Salisbury Road Castle Hill NSW



CLEAN STORAGE ONLY | EXCELLENT LOCATION | POPULAR COMPLEX

This exceptional property is situated in the highly sought-after Catalyst Business Park, located directly off Victoria Avenue's busy trading precinct.

The complex is well located within Castle Hill's industrial and trading zone, only minutes to the new Castle Hill Metro station, M2 motorway and renowned Norwest Business Park.

Features Include:

[For full version visit the website](https://www.hillscentral.com.au)

Type : Industrial
Building Size : 261 sqm
View : <https://www.hillscentral.com.au/lease/nsw/hills/castle-hill/commercial/industrial/8424030>

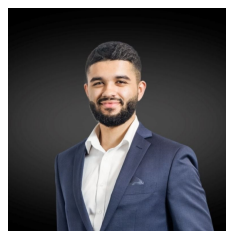

Zartosht Sundal
02 9634 2299

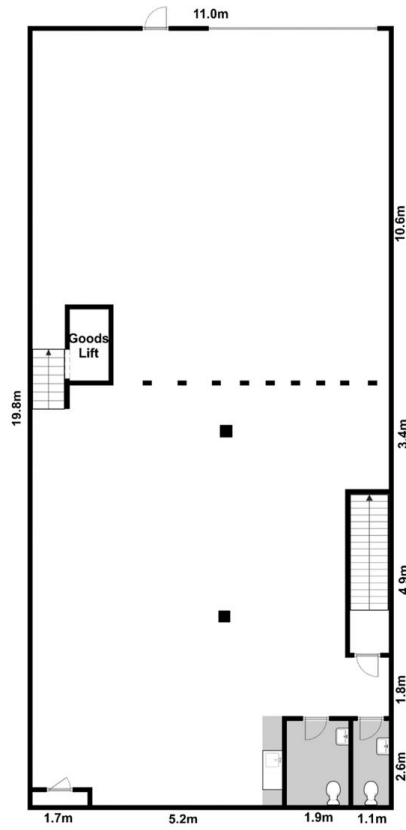

All Dimensions and figures contained in this advertisement are given in good faith and are believed to be correct. However, we cannot guarantee its accuracy and interested persons should rely on their own enquiries.

9 Salisbury Road, Castle Hill