

### 120/7 Hoyle Avenue Castle Hill NSW



Exceptionally presented unit, located directly off Victoria Ave, offering easy access to major arterial roads and motorways.

Located on the highly desirable upper podium level, which offers easy access for both cars and trucks, offering excellent vehicular manoeuvrability.

This warehouse is tastefully renovated throughout, perfect for showroom users, design studios or for a training facility, with polished concrete, reverse-cycle air conditioning, internal open-brick walls, amazing decorative lighting throughout, and a unique timber ceiling.

**Type** : Industrial  
**Price** : Contact Agent  
**Building Size** : 228 sqm  
**View** : <https://www.hillscentral.com.au/sale/nsw/hills/castle-hill/commercial/industrial/8663812>



**Simon Russo**  
02 9634 2299

[For full version visit the website](https://www.hillscentral.com.au)

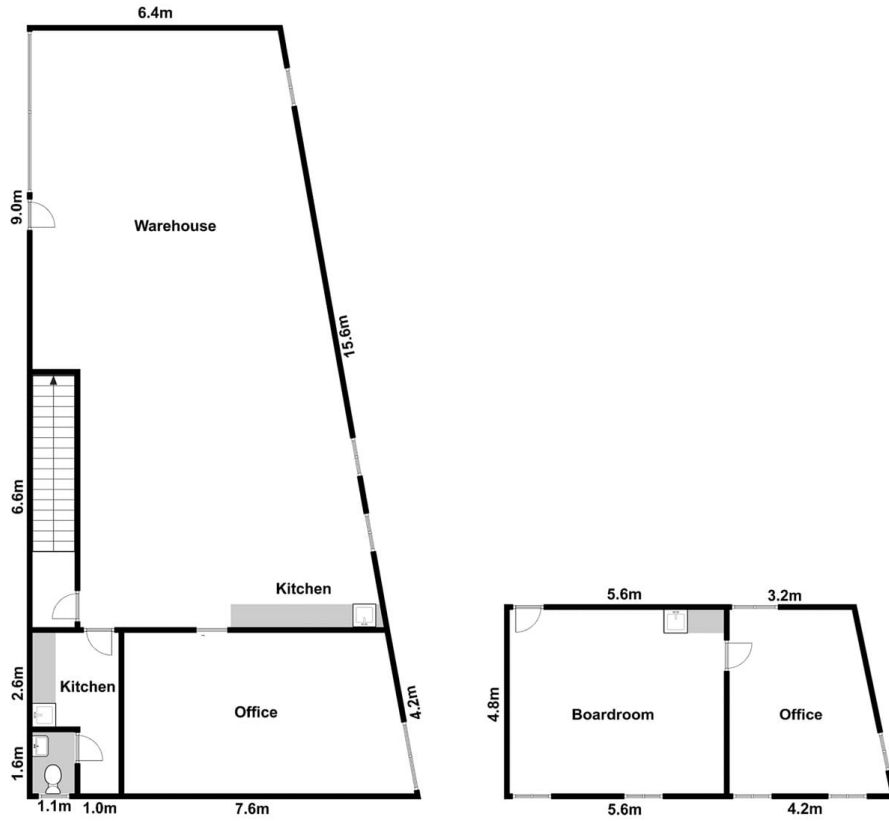

All Dimensions and figures contained in this advertisement are given in good faith and are believed to be correct. However, we cannot guarantee its accuracy and interested persons should rely on their own enquiries.

**120 / 7 Hoyle Avenue, Castle Hill**